



PALM BEACH RADIO CONTROL ASSOCIATION



HAPPY HOLIDAYS, MERRY CHRISTMAS AND HAPPY NEW YEAR TO ALL.

AMA CLUB # 1016 IMAA #12

DECEMBER

2009

President

Doug Christensen

Doug@palmbeachrc.com

Vice President

Joe Brusco

Joe@palmbeachrc.com

Past President

Howie Kelem

Hkbigwheel@aol.com

561-638-8440

Secretary/Webmaster

Walt Dreyfus

wdreyfus@bellsouth.net

954-481-5327

Treasurer

Woody Rackoff

woody@palmbeachrc.com

Director

Events Coordinator

Ed Christiansen

Ed@palmbeachrc.com

Director

Newsletter Editor

Steve Westervelt

Steve@palmbeachrc.com

954-275-4057

Director

Chief Training Instructor

Mark Drogowitz

Mark@palmbeachrc.com

561-676-3120

Director

Safety Coordinator

Cliff Auerbach

cliff@palmbeachrc.com

561-289-3668

Director

Arty Mundell

arty@palmbeachrc.com



The Presidents Message...

December 2009:

I personally want to thank all those members and sponsors who pitched in to make our first Toys for Tots event a roaring success. In spite of the weather, members contributed over \$1000 worth of toys and cash to be donated to local needy children. The United States Marine Corps were present to collect the goodies and fly one of our trainers while they were attending. Huge thanks to Alex Acuti for organizing this event. Look for this successful event to be repeated next year.

Dave Rettig will be championing building new starting stands. Our existing stands have seen better days and are need of replacement. If you are interested in working with the team to build new stands, look for an email from Dave then the build days are finalized.

It's been an interesting year (for sure for me). Thanks to all the members and volunteers that help out every day at the field. We really have a great place to fly and the entire membership is responsible for that. As we fly into 2010, let us keep our field a premier flying site. Let's fly safe, use common sense, communicate on the flight line, help out the new guys and gals, volunteer and give way to our wonderful County maintenance crews.

That is all I have for this month. See you at the field.

Altitude, Airspeed, and Luck. You need at least two. **Doug Christensen**



So the holidays are here and soon will be gone but this last year for PBRCA has made many great memories for many members. My request for this next year is that the membership share those memories in stories included in each and every newsletter. Now it's all up to you!! **Steve**

PBRCA MEMBERS **REMEMBER RENEW YOUR AMA MEMBERSHIP
NO ONE CAN FLY AFTER JANUARY 1ST, 2010, WITHOUT IT.
AMA MEMBERSHIP MUST BE CURRENT TO RENEW IN PBRCA**

**IMPORTANT DATES TO
REMEMBER:**

Wednesday, January 6, 2010

Board Meeting 7:00 PM
COCONUT COVE WATER
PARK.

Thursday, January 14, 2010

General meeting 7:30PM
South County Civic Center
16700 Jog Road.

Sunday, Jan 16 & 17, 2010

AMPS PATTERN CONTEST

Saturday, Jan 16th, 2010

MPPA Night fly Markham Park

Friday, Jan 15th, 2010

South Florida Fair

Delta Dart building - see below this
page for more info "event update"

Wednesday, February 3, 2010

Board Meeting 7:00 PM
COCONUT COVE WATER
PARK.

Thursday, February 11, 2010

General Meeting 7:30PM
South County Civic Center
16700 Jog Road.

Sunday, February 21st, 2010

SWAP MEET

South County Civic Center
16700 Jog Road.

Sat & Sun, Feb. 27-28, 2010

Electric Fly

Wednesday, March 3, 2010

Board Meeting 7:00 PM
COCONUT COVE WATER
PARK. FOR MORE INFO ON OUR
EVENTS - GO TO OUR WEBSITE IT
WILL KEEP YOU UP TO "DATE"



**PALM BEACH RADIO
CONTROL ASSOCIATION
NOVEMBER 12, 2009**

The meeting was called to order at 7:30PM
New members and guests were introduced.
The October minutes were approved as read.
The treasures report was read
OLD BUSINESS

- Doug talked about the IMAC HURRICAN CLASSIC We raised a possible \$1000
- Doug recognized the Volunteer workers
- Our Turkey Fly will be November 22 we will give away 20 @10 gift cards
- Doug talked about Cart usage. A waiver must be signed, key deposit \$10 Get keys from Doug.
- The road in front of the press box is for loading and unloading. No parking.
- Nomination of officers open in December Close in January The existing President and Vice President can not run again
- Remember no flying alone this include the Heli Area.
- We thanked Joe and Walt for getting the press box fixed

NEW BUSINESS

- We will hold a fun fly event Sunday December 12, 2009 for TOYS FOR TOTS to enter you must bring a new unwrapped toy.
- The South Florida Fair will be held January 16-31 2010 volunteers are needed see Doug
- We will have an Electric fun fly Saturday and Sunday February 6 and 7 2010
- Our Swap Meet will be held Sunday February 21
- The Rhinebeck event might be held the last weekend in March this will be discussed at the Bd. Meeting
- We had a proposed by-law change
- 1. The president and Vice-President may not be elected to serve more than two consecutive years in ant one office. The president and Vice-President shall not be active officers of any other model airplane club. *In the event there are no nominees for President at the end of the present term, the sitting President shall be allowed to serve the upcoming year.*
- Chris told the members there will be a combat event at the bush pilots in April

REMEMBER SAFETY FIRST

We had Show and tell

MEETING ADJOURNED 8:45 PM

RESPECTFULLY SUBMITTED WALT DREYFUS SECRETARY

EVENT UPDATE:

SOUTH FLORIDA FAIR

January 15th to 31st

Volunteers' help children build AMA Delta Darts

Free of charge and will get free admission on the days they volunteer.

Please contact Pete Ferris 561-369-3333 or Doug Christensen 561-966-5602 & Arty 561-964-3245 to sign up.



**PHOTOS - SOME NEW
SOME YEAR END & SOME OLDIES
BUT GOODIES**

May I have your attention please...

**Time for Club Business...
Elections!!!!**

Nominations opened for all elected positions at the December General Membership Meeting.

Nominations *close* at the end of the January General Membership Meeting.

***ELECTIONS* to be held during the February General Membership Meeting.**

***Positions* are:**

President, Vice President, Secretary, Treasure, Newsletter Editor, Chief Safety Officer, Chief Instructor, and Director (Events Chairman).

THANK YOU FOR YOUR ATTENTION TO THIS MATTER PLEASE BE IN ATTENDANCE SO YOU CAN VOTE FOR THE NEW BOARD MEMBERS !



(Photo's continued)



This is a "working trailer" for RC Aircraft! And it is for sale!

I can get you to the owner if you want this trailer

Well that's the "pics for the year!!" Remember I want you all to share your flying stories and photos send them to me, please!

For example I ask for stories... here are two of the best writers that have always helped out with the efforts of this newsletter. Let's share their stories now!
First up: Past President Ray Murtha who is still a member, but lives a little farther away than most of our membership. Here is his update to share. SBW

Building My Workshop

Part 1 – Site Preparation

Greetings from Stapleton, Alabama. The house in Coral Springs has been sold and we are completely moved in to our new home. We have 3 major move in projects to complete. A swimming pool (for my wife), screening in the back porch (the flying critters are as big as your fist and they are hungry) and a workshop (for me).

The first order of business was to clear some additional land behind the house. The old fence ran at an angle across the backyard and we decided to square it up to make more room and to bring a few trees into the yard. Picture 1 shows the corner where the workshop will go. The wire fence will be moved back and the gate will be put in a more useful location.



Next comes the farm equipment. Marvin is clearing the land for us with a tractor and a “bush-hog”. This is what it looked like after Marvin was through. We were able to bring 8 trees into the yard.



Here is what it looks like now (Oct 2009). The building will be set parallel to the wooden fence about 5 ft to the right of the new wire fence. The pile of dirt in the foreground is from the swimming pool, which started this week. Part 2 will document the pouring of the slab, which should start next week. Then about a month after that the building will be erected. Just in time for the holidays.

Part 2 – The Slab

The next step was to get the slab built so that the building had something to sit on. We decided on having the building ‘engineered’, which means that it comes with a 130 mph wind load rating. The Mobile area has had 2 hurricanes and 2 near misses in the past 6 years.

It took about a week to get the engineering drawings which contained the specs for the slab. Here is the building drawing showing the Wrol-up garage door and walk in door. Because these are on the side of the building, they had to be preplanned when the ribs and trusses were manufactured. The door that goes on the right end of the building and all the windows (4) are not shown because they did not need any special engineering.

The next step was to contact Clarence (he's Marvin's cousin) and get the slab ready to pour. The corner where the building will be has a slight low spot, so we decided to build up the area so the slab was about 6 inches above the surrounding area so standing water would not be a problem. Here's how it looked as they graded the land a laid out the formers.

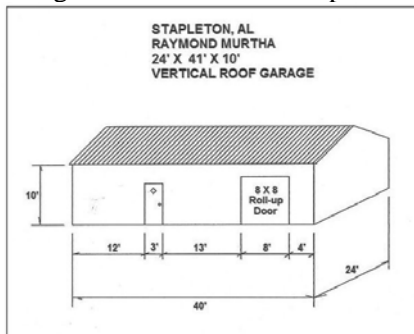

The concrete pumper was gone before I got home from work, so there aren't any shots of the actual pour, but when I got home they were finishing the top of the slab. The slab measures 24 feet ¾ inches by 40 feet, 4 inches thick. The edge of the slab has a 12 inch by 12 inch footer with rebar reinforcement.



So now we have a slab (my Mom says it looks like a skating rink), that's the good news. The bad news is that the concrete has to cure for 30 days. I called Carolina Carports and let them know that I would be ready for my building anytime after December 16th, so hopefully I will have it in time for Christmas.

**Shut up and Fly,
Ray**

(Well that was all supposed to get into the last couple of months newsletters, but since I combined them we ran out of "share space." Now in this year end issue I have the finished pics to add! – **Steve**



Ray; Looks like a great place for your planes to live and to build new ones in, but seems you were also busy with another project as well, something you learned about living here? **Something you had to bring along?**



I Need a finished pool pic!

Looking good Ray. Send more on updates please tell us what model is "first to be built" on that worktable.

Now we are going back a month back to "build 5". Seems Dave has "Word 2007" and I have "Word 2003". So his file was given me fits to open but I have mastered the problem and here is the build that should have been in the three month issue that was out last week. That issue has "build 6" so read this one first then go back to the other and read it! OK, Right!

Like I have stated many times anyone who wants in on this jump! Give me a call we will share!

And now Dave: Scratch C -131 number 5...

Scratch Building C-131

Part 5 – Final prep and covering

Now that all the sanding has been done, I had to figure a way to build the frame for the front windshield. I used 1/8 balsa strips and shaped them to fit the fuselage. I will then attach the plastic to the frame and attach the entire unit in two sections to the fuselage. I had to wet the balsa to get the shape.

I painted the inside of the cockpit grey. I will glue the frame in place before I cover the nose. This way the covering will be finished tight to the frame. The frame will be glued directly to the balsa so as to get a good bind. I put the fuselage aside for the time being.



The first covering job was the control surfaces, flaps and stabilizers both vertical and Horizontal and the ailerons. The choice of covering was Ultracote. I have found through the years that it is a better material to work with. For one thing, the color is applied to the top of the covering. This makes removing it, if necessary without having the color stick to the surfaces. Monocote has the color put on the bottom of the covering and when you remove it, the color tends to remain on the surface of the balsa.

Just some information about working with Ultracote. First of all NEVER use a heat gun on it. The heat that is produced by a gun is too hot and will cause the material to pull free on the edges and if you over lap the colors, it will pull back. I use a heat controlled iron. The temperature is set for about 210-215 degrees. What I usually do is try tacking the covering down at about 205 degrees and test the covering to see if it sticks. If it doesn't, I increase the temperature until it holds. This way you can easily remove the covering if you make a mistake. I tack a corner first then pull the material tight to the next corner, making sure that there are as little wrinkles as possible. Then I tack the middle ends by pulling the material tight. If you find wrinkles, lift the corners and pull them out. After this is done, start in the middle of the covering and work your way to the outside. This way you will trap very little air under the material. Always do the underside of the plane, wing and control surfaces first, overlapping the edges when you do the top.

After you have completed the entire surface top and bottom, you can start to tighten the material. Increase the heat to about 285 degrees. Try to shrink the material in a small area, preferably in the center. If it starts to shrink, continue to do the entire surface. If not, increase the heat gradually. After the material has been tightened, go back and check for areas that are still not tight enough. Increase the temperature slowly until you have removed the stubborn wrinkles. Remember that you should never go higher than 320 Degrees! Oh yes, any places where the air is trapped can be fixed by sticking a pin in the middle of the raised area and holding the gun just to the side of the hole. In some cases you may have to hold the iron on two sides of the hole. If it is a large area, poke a couple of holes in the covering with the pin.

I chose to cover the wing first. The pictures are included here. I was happy with the job. The only problem that arose while covering the wing was the nacelles. Because of the bends and curves, I had to cover it in strips of material 3 inches wide. This worked out well. A picture of the completed wing is shown here. That's it for this session. Hopefully by the next article I will have completed the fuselage. I also will explain the problems that I ran into fastening the cowls and installing the retracts.

Happy flying
Dave Rettig

May I have your attention please... This **“special service award”** goes to the **Palm Beach County Staff** “team members” Thanks again to all the crew for a job well done. Not to forget our main team leader Walt. He makes sure he is involved with these crews as they groom our park. Great efforts, yield great results! That shows, just take a look!! We have improved the site again this past year with Oak Trees and new fenced in heli area. PBRCA wants to be sure to thank **Palm Beach County Parks and Recreation** for all they do for us and together, as this team continues, this new year will bring “more greatness” again.

Thank you!!

BOD, PBRCA



ANNOUNCEMENTS:

FIELD UPDATE:

Radio Impound. A Reminder that, per our rules, you are required to return your frequency pin and transmitter to impound when you are not flying. With our increase in traffic at our field, we need make it easier and safer to share frequencies. Please return your frequency pins to impound when not flying. Don't make others search you down to get a pin. This is a critical issue at our site and we need to enforce the impounding rules to reduce the chances of frequency collisions. It's just common courtesy.

DSS radios: Per our rules, DSS transmitters **MUST** follow the same impounding rules as the 72Mhz radios. You **MUST** clip your club or AMA card at impound and you **MUST** take a DSS frequency pin. This procedure helps us to verify ALL pilots are AMA or club members. DSS radios must be returned to impound when not in use. Please remember to return the DSS pins when done.

Pilots and Pits: Everyone that crosses the spectator fence **MUST** have a club card or AMA card. Please challenge anyone you do not recognize and ask for proof of either membership. If they do not produce a card, ask them to return to the south side of the fence. With our increase in guest traffic, this has become a major liability issue for us. This rule applies to children as well. Small children with credentials must be escorted in the pits per **AMA & PBRCA** standards.

New Heli area - DSS only. Heli's only!

AMA Renewal: It is 2010 and you must be renewed to fly. Do it by email it will get you back in the air faster!

Club renewal: Be sure to get your decal from Walt when you renew!!!

Thank you, more updates to follow each month. Our goals on safety will never change, but unsafe pilots... will. If they want to have flying rights at this field, **Period.** **Palm Beach County Staff** expects nothing but the safest flying conditions at this site and that is what we **“The PBRCA host club”**, are going to give them!! Bet on it.

MORE NEXT MONTH FROM OUR SAFETY GUY AND NOTES FROM THE TEACHER!

LOCAL HOBBY SHOPS

3 G's Hobbies

1379 N. Military Trail, West Palm Beach
1-95 to Belvedere Road, travel west to
Military Trail. Travel north on Military.

G&C Hobbies

561-547-3812
1228 Hypoluxo Road. I-95 to Hypoluxo Road, exit
East. The store is ¼ mile on the north side.
M-Sat 10-6, Sun closed

Belzers Hardware Store

561-391-7977
3198 N. Federal Highway, Boca Raton
I-95 to Yamato Road. Exit east to Federal Hwy. South
on Federal Hwy. Store is on east side of Federal
Highway
M-F 8-6 Sat 8-5 Sun 11-4

Radio Controlled Revolution

561-684-2772
2275 Palm Beach Lakes Blvd. Suite A
West Palm Beach, FL 33409
Northwest corner of Palm Beach Lakes and
Okeechobee next to Sound Advice
www.rcrevo.com

Ready Heli & Ready Planes

Jennifer Greco
354 Cypress Dr. # 7
Tequesta, Fl. 33469
Phone number 561-575-1118
Sales@readyheli.com

RC Boca Hobbies

561-483-2540 Email: JR@RCBoca.com
561-483-2541 WEB www.rcboca.com
20449 State Road 7 (Mission Bay Plaza) Boca
Raton in LA Fitness Courtyard Area
M-W-R 11am-7pm F 11am-6pm Sat
10am-6pm Sun 10am-5pm

RC Hobbies

954-721-5720
<mailto:www.rchobbies.net>
6800 N. University Drive, Tamarac
I-95 to Cypress Creek exit. West to University
Drive. Southeast corner of University and McNab
Road. Or take 441 to Sample Road, west to
University and south to McNab. (Cypress Creek
turns into McNab)
M-F 9-8 Wed (xmas now open!) Sat 10-5 Sun 10-3
Closed Wednesdays after the holiday.



MDI Racing
0255 Southern Blvd, Royal Palm Beach, FL 33411
(561)798-2433
www.mdiracing.com



SANTA AGAIN FLEW IN BY HELI TO OUR HOUSE THIS YEAR!

FINAL WORD:

This has been another amazing year! We have done it again... safe flying, fun and award winning events.
We even have Oak Trees now!!! Who could ask for more...wait I know the answer to that!! **SBW**